

# E-Töffli Power



**Emofa**  
We ride electrically

Emofa AG, Rietgass 8, CH-8197 Rafz-Zürich, Telefon +41-44-945 39 39, Fax 044-454 20 21, [emofa@emofa.ch](mailto:emofa@emofa.ch), [www.emofa.ch](http://www.emofa.ch)

## Vehicle information

### Main components

Name of E-bike	E-Töffli Power
Length	1770mm
Width	680mm
Height	1050mm
Wheelbase	1200mm
Height above ground	120mm
Seat height	730mm
Capacity	one person
Weight	59kg
Range	35km
Climbing ability	6 degree
Motor type	Brushless
Rated output	800w/1000w
Rated torque	12N.M
Battery type	lead acid battery/lithium battery
Battery voltage	48v(12v* 4)
Battery capacity	12Ah/17Ah
Battery driving	sealed maintenance-free battery
Low voltage protection value	42V
Value over current protection	17A

Brake	Front	front & rear drum break
	Back	
Tire size	Front	2.125-18/2.5-18
	Back	2.125-18/2.5-18
Tire pressure	Front	250kPa(2.50kgf/cm <sup>2</sup> )
	Back	270kPa(2.70kgf/cm <sup>2</sup> )

## Vehicle Information

Frame number

Frame number is the special number for the vehicle. It will be used in insurance, repair, routine attention.

**Frame number is which the arrow points to**

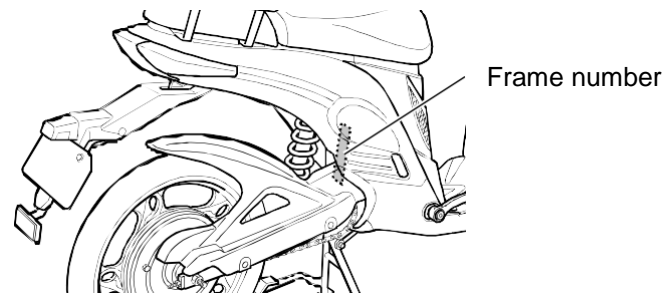

Name of E-bike	E-Töffli Power
Frame number	

## Spare parts

The view of vehicle (Front)

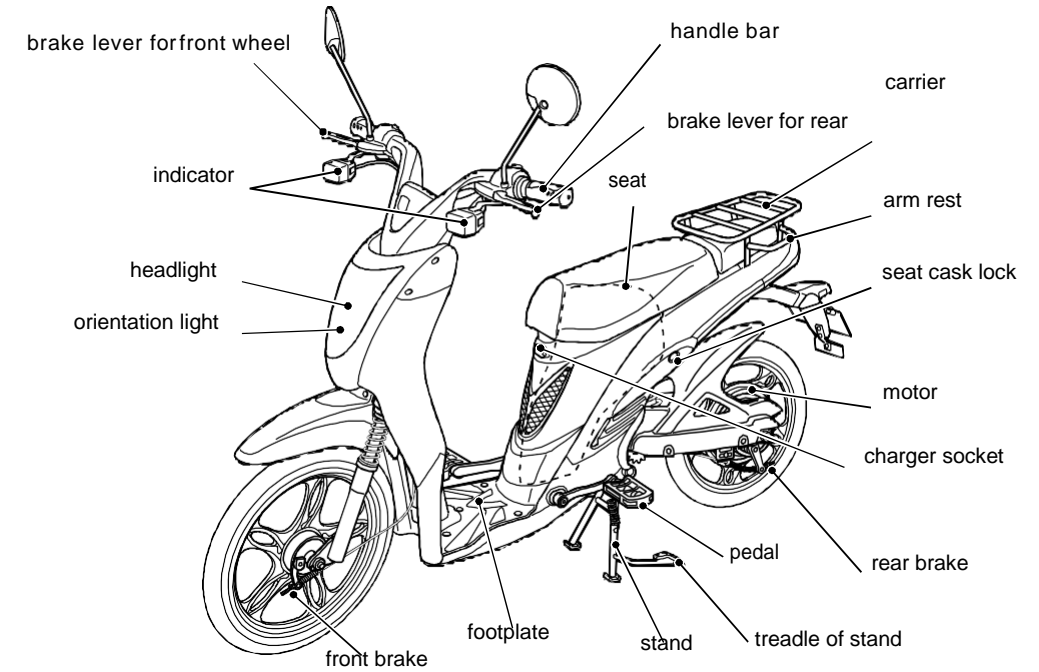

## The view of vehicle(Back)

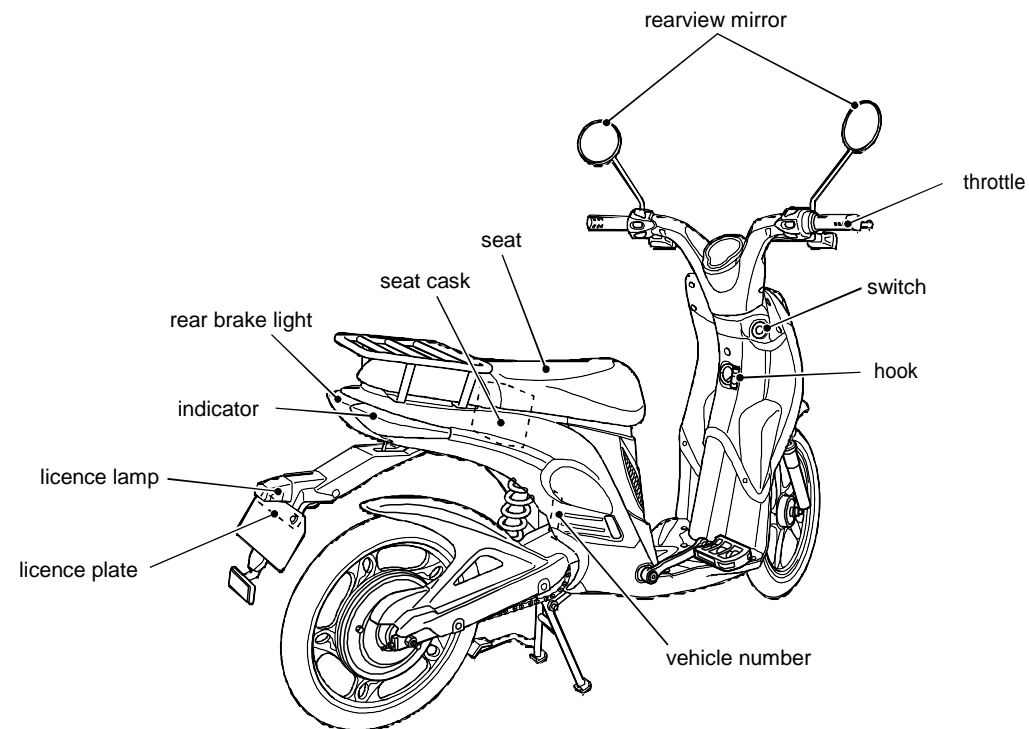

## Meter and Switches

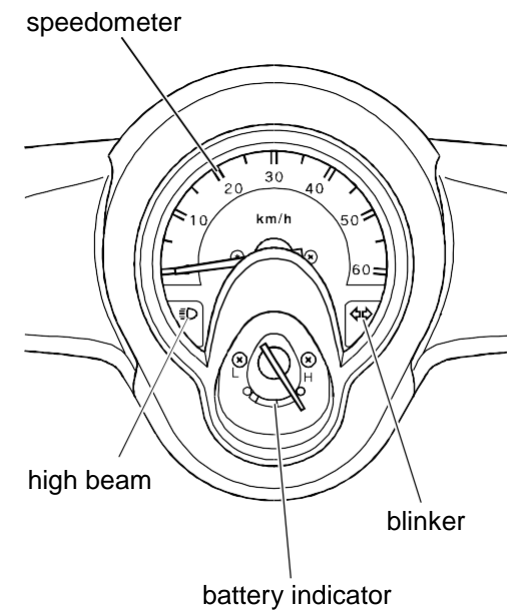

## Around the handle bar

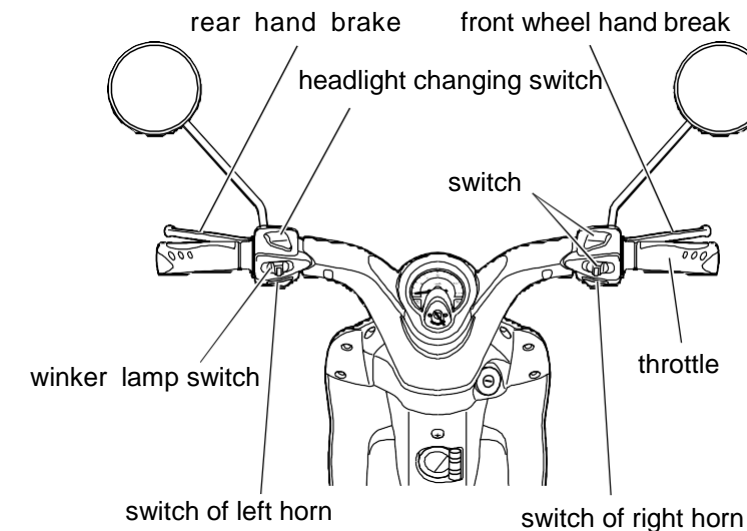

## How to use the key

The key is used to switch on the bike and lock the compartment under the seat, it's important, please keep it safe and don't lost it.

This vehicle is equipped with two keys, please keep one of them well, so that you can reserve. if lost or damage, please replace that with following parts.



### ⚠ Notice

Please attention when you use the metal keychain, do not use more than two keychain, in order to avoid scratching surface of bike, you had better use cloth keychain.

## Main switch entity

main switch: start power (ON/OFF)  
steering wheel lock (lock/unlock)

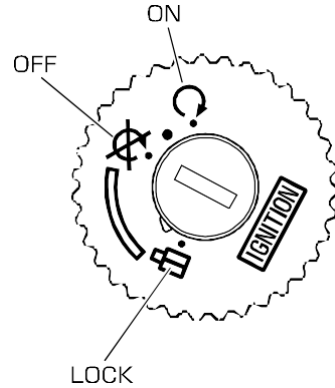

## Power ON/OFF

### ON

When the key is in this place, the headlight, instrument light, blinker, tail light and licence light can use, if motor supply power normally, this e-bike can start.

### OFF

When the key is in this place, the headlight, instrument light, blinker, tail light and licence light extinguish, power stop, e-bike can't keep riding, at this time you can take out the key.

## Trouble shooting

How to resolve the symptoms which need repaired, given to the nearest repair shop, or please contact with service center.

Symptom	Reason	How to solve
Can't charge the power	The plug of the charger is off	Whether the charger connect well according to the instruction.
	The fuse of the charger is cut off	Change the fuse according to the instruction.
	The charger is broken	The charger need to be repaired.
	The fuse of the battery is cut off	Change the fuse of the battery.
	The electrical system has an unusual	The electric wire, connector, return circuit need to be repaired.
Exclusive use charger can't charge enough in 12 hours (The safety green light is not lighted)	Can't charge enough	Long time not use after the first charge, the charging time will be longer, please charge enough in one time.
	The function of the battery is low	Need to replace the battery, the life of the battery is connect with the driving distance.
	Wrong way to charge	Please refer to the charging instruction.
	The setting of the charger doesn't match	Please refer to the charging instruction.

Symptom	Reason	How to solve
The scooter is not moving when the switch is on.	The fuse of the battery is cut off	Change the fuse of the battery.
	The electrical system has an unusual	The electric wire,connector,return circuit need to be repaired.
When the switch is on,the head light and horn is normal,but the motor doesn't work.	Brake lever cannot get back to its original position	If the brake lever can't get back to its original position when it is not used , please turn off the headlight,cut off the battery,then the brake lever will recover.
	Vehicle dynamic system, electrical system fault, please repair (motor, etc)	Need to be repaired
When the switch is on,the motor is normal,but the head light and horn doesn't work.	The electrical system is fault	Need to be repaired
Can't speed up.	Without using of special charger to charge	Please use exclusive use charger
	The remain battery power is small, can't speed up	Please use exclusive use charger
	The using period of the battery is finished.	Due to the different speed, different driving conditions(loading,wind load etc)

Symptom	Reason	How to solve
Can't speed up	The using period of the battery is finished.	Need to replace batteries.The life of battery is different according to the driving condition.
Driving distance shortened	Without using of special charger to charge	Please use exclusive use charger.
	The charging time is not enough	He indicator lights of the charger shows green,the battery is full.
	The fuse of the charger is cut off, can't charge any more	Please transfer the charger to normal refer to the charger instruction.
	External temperature is low	It is most suitable for using the vehicle in 10°C ~ 30°C.It will shorten the life of the battery in cold weather.
	Overload driving	The driving range and speed of the vehicle will be different according to the different driving condition (loading,wind load,etc).
	The pressure of the tyre is under-inflation	Please adjust the pressure of the tyre to normal.
The pressure of the tyre is under-inflation	Need to replace batteries.The life of battery is different according to the driving condition.	

Symptom	Reason	How to solve
The driving distance shortens	The battery faults	Please change the battery.
The throttle is not operative (speed instability, the brake statement is faulty in driving)	The power of the battery is less, the voltage of the battery is not enough	Please use exclusive use charger.
	The throttle is unnormal (The throttle doesn't work, too loose, or too tight, the connector is lost)	Please repair.
The brake is unnormal	It inflows when driving in the puddle	Please dry the wet part of the brake.
	The brake regulator is not adjusted fully	The braking effect is influenced by the adjusting the brake regulator.
	The brake pads finish their life	Change the brake pads.
Stops suddenly when driving (throttle doesn't work)	The battery meter shows charge to low	Please use exclusive use charger.
	The voltage of the battery is unnormal, the fuse is cut off	Change the fuse of the battery.

Symptom	Reason	How to solve
Pedal idling	<ul style="list-style-type: none"> <li>Chain is lost</li> <li>Chain snaps</li> <li>The power transmission unit like gear is faulty</li> </ul>	Need to be repaired
The pedal is not turning	The position of the pedal and crank is not correct	Please adjust the crank and pedal in correct way
The pedal is lost in the driving	<ul style="list-style-type: none"> <li>The screw which assembles the crank and pedal is loose</li> <li>The pedal is assembled in the opposite</li> </ul>	Please repair if can't adjust the pedal and crank correctly



# Change the fuse

## The fuse of battery

**⚠ Attention!**

When replacing the fuse, be sure to close the vehicle power, and don't connect the battery wire, if so, it may be short and will be dangerous.

- 1 To open the seat, please put the key into the lock under the seat and turn right.
- 2 Open the seat from the behind slowly.

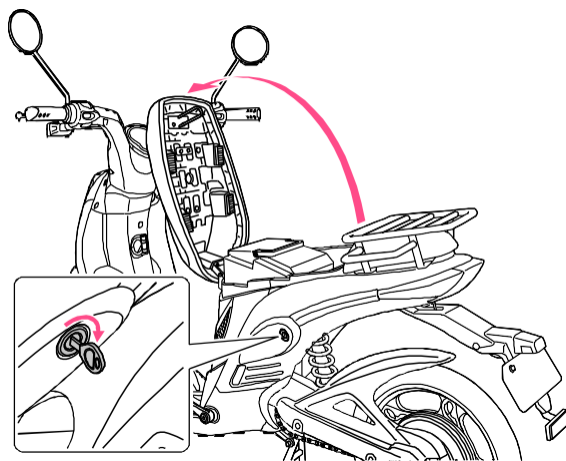

- 3 Take off the wires of the battery.

- 4 Take off the nut of the fuse.
- 5 Change the fuse

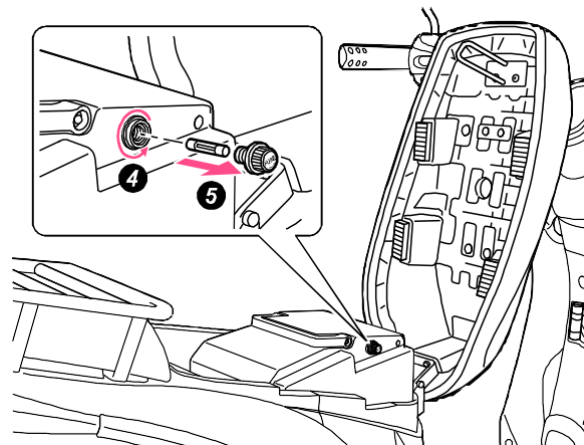

12

**Emofa**

We ride electrically

# Change the bulb

## Position Lamp

- 1 Take off the screws which fix the position lamp lens.
- 2 Take off the position lens.

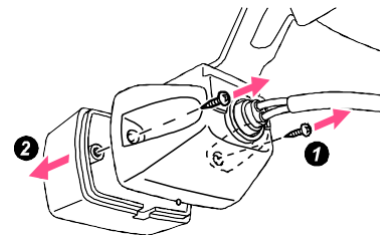

- 3 Change the bulb  
The headlight bulb can be taken off by turning the bulb opposite.

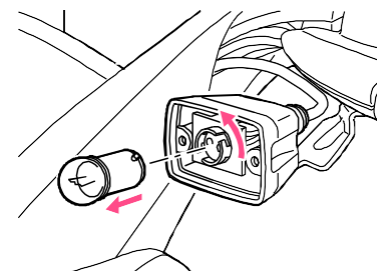

## Headlight bulb

- 1 Take off the headlight lens.

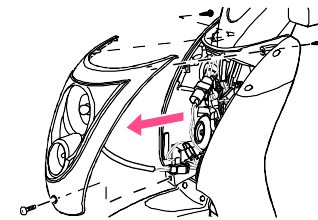

- 2 Change the position lamp bulb.
- 3 Take off the screws which fix the headlight lens.  
Take off the long filament.

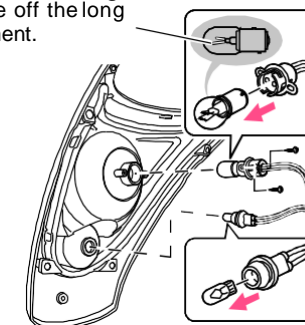

The bulb is LED. Please pay attention to the direction of the bulb. Please test it after changing, if it is not lighting, try to turn opposite.

**⚠ Attention**

Replace the bulb, pay attention to the positive and negative, if opposite, the high beam and low beam will be opposite, it will be dangerous.

## The speedometer light

- 1 Take off the screws which fix the speedometer.

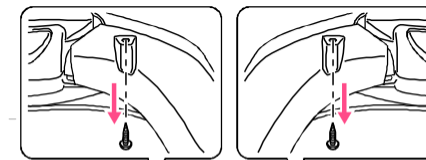

Handle bar A

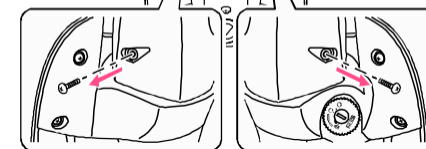

13



- 2** Take off the plastic parts of the handle bar A. There is 4 fixing hasps on the plastic parts. Put the screwdriver into the certain hasps and it is easy to take off the hasps.

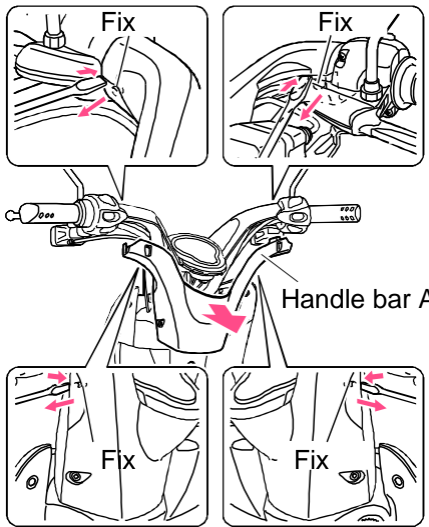

- 3** Take off the screws of the handle bar B

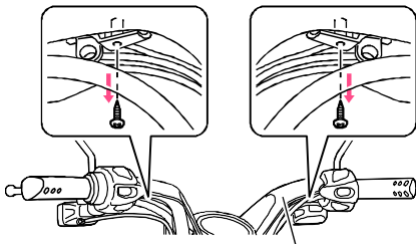

Handle bar B

- 4** Take off the plastic of the handle bar B.  
**5** Pull off the plug at the bottom of the board, change the bulb.

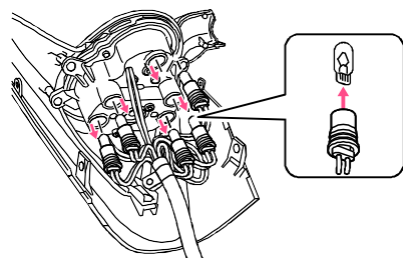

### The bottom view of the speedometer

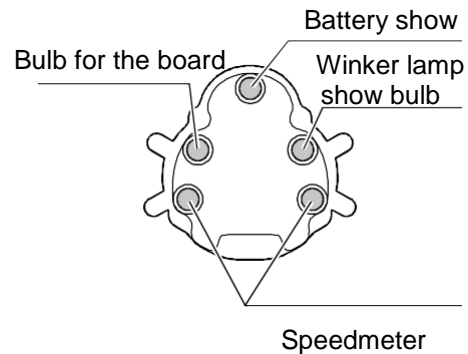

- bulb for the board x3 (speedmeter, battery show)
- High beam x1
- Winker lamp show bulb x1

#### ⚠ Attention

If there is free wire connections, please don't connect wires, lest it will damage the vehicles.

### Licence lamp

- 1 Take off the screws which fix the licence lamp.
- 2 Take off the licence lamp.
- 3 Take off the screws which fix the rear fender.
- 4 Take off the rear fender.

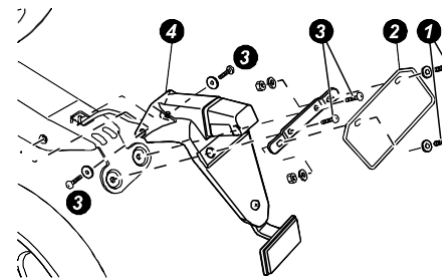

- 5** Take off two nuts which are inside of the rear fender. Take the lamp from the rear fender.

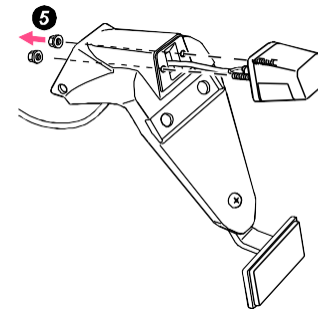

- 6** Take off the lens.  
**7** Change the bulb.

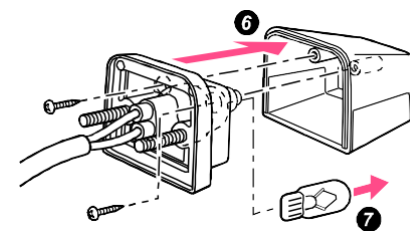

### Tail light

- 1** Take off the screws which fix the tail light.

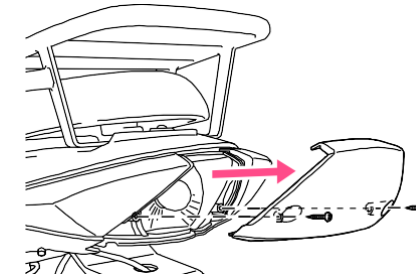

- 2** Change the bulb.

Turn the bulb opposite and take it off. Install the bulb, turn the bulb clockwise.

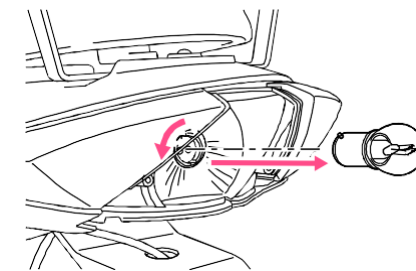

## Rear winker lamp

Please take off the battery when changing the rear winker lamp.

- 1 Take off the screws which fix the seat.
- 2 Take off the seat.

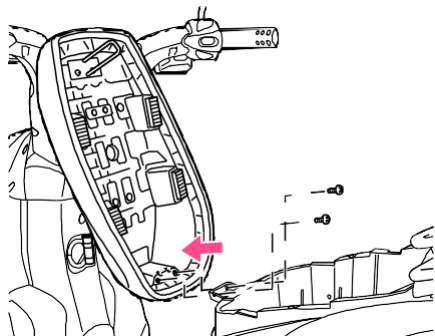

- 3 Take off the screws which fix the rear seat.
- 4 Take off the plastic parts in front of the rear seat.
- 5 Take off the rear seat.

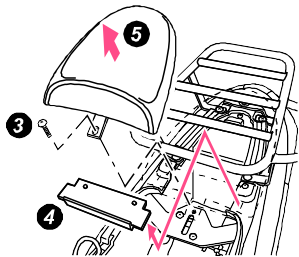

- 6 Take off the four screws which fix the rear rack.
- 7 Take off the rear rack.

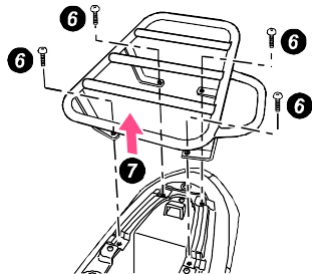

- 8 Take off the screws which fix the body cover under the seat.
- 9 Take off the connector, take off the seat cover.

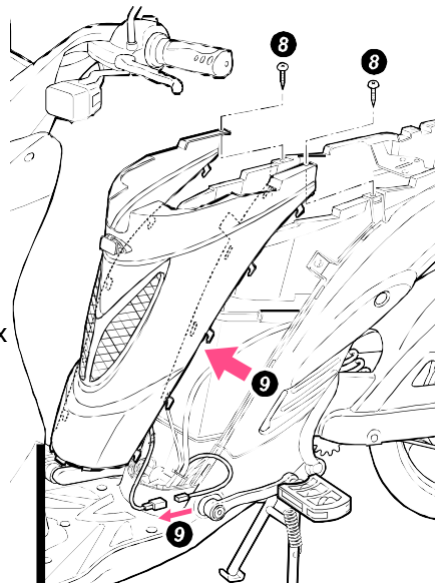

- 10 Take off the all the screws which fix the plastic parts.

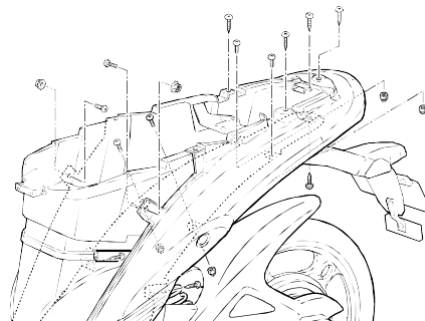

- 11 Take out the wires with pliers, the front of the wires need to be fixed.

- 12 Take off the cover carefully and softly, or it will damage the cover.

### ⚠ Attention

Move to add Saidokauru excessive force, may be broken Saidokauru claws.

Take off the body cover.

13

⚠ Attention  
it is impossible take off the body cover completely because the wires is fixed together.

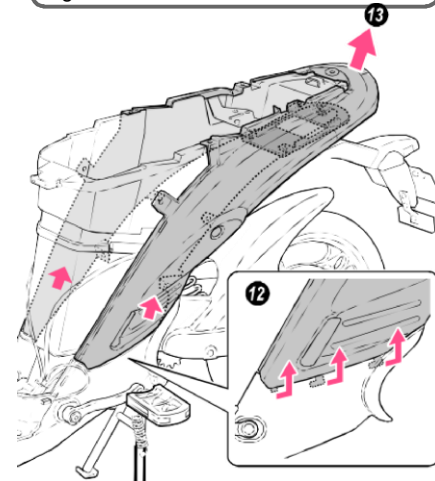

- 14 Pull of the plug, change the rear winker lamp.

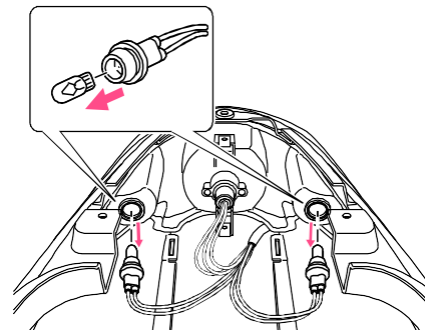

### ⚠ Attention

This manual is only for reference. The exact condition please according to the vehicle.